



## Before You Begin

READ THESE INSTRUCTIONS COMPLETELY AND CAREFULLY



## UNPACKING

- Unpack and carefully examine the product.
- Report any damage and save all packing materials if any part(s) were damaged during shipping.
- Do not attempt to install or use this equipment if it is damaged.

## INCLUDED IN THIS BOX

- LED Fixture.
- Installation instructions.

## **WARNING – RISK OF FIRE, ELECTRIC SHOCK, INJURY, OR PROPERTY DAMAGE**

- Failure to follow these instructions or altering equipment could result in injury or damage and void warranty. Venture assumes no liability for injury, damages or losses of any kind that may arise from the improper, careless, or negligent installation, handling or use of this product.
- This equipment must be installed and serviced per applicable codes and ordinances by qualified personnel (ex. licensed electrician) familiar with the operation of the product and any hazards involved.
- Disconnect power to the equipment and allow to cool before installing or servicing
- Handle sharp edges with care. To prevent wiring damage, do not expose wiring to sharp edges.
- Verify that all electrical connections have been properly made and the fixture is grounded to avoid potential electrical shocks.
- It is the installers responsibility to confirm the proper input voltage is used with this equipment.
- Do not handle energized equipment when hands are wet, when standing on wet surfaces, or in water.
- This fixture must be mounted securely to a ceiling or structure to support the weight.

## SUPPLIER'S DECLARATION OF CONFORMITY (SDoC)

This equipment complies with the limits for a Class A digital device, pursuant to Part 15 Subpart B of the FCC Rules. These limits are designed to provide reasonable protection against harmful interference when the equipment is operated in a commercial, industrial or business environment

## IMPORTANT SAFETY INFORMATION

- Operating temperature: -25°C to +40°C (-13°F to +104°F).
- Suitable for use in wet locations.
- All wiring and connectors used with this equipment shall be rated a minimum of 90°C (194°F).

## Installation Instructions

- 1: Disconnect power from the luminaire and follow proper lockout/tagout procedures before beginning installation or maintenance.
- 2: Remove the existing luminaire. Dispose of the existing lamp(s) and ballast(s) per local requirements.

- 3: Screw the aluminum pipe into the fixture heatsink. (Figure 1)
  - 4: Screw the safety cable provided into the heatsink. (Figure 2)
  - 5: Drill the installation hole into the ceiling. (Figure 3)
  - 6: Secure the safety cable to the ceiling. Attach installation plate to aluminum pipe then secure the fixture to the ceiling. (Figure 4)
    - a) Use provided plugs to cover mounting screws on fixture face.
  - 7: Remove the lid from the driver compartment. (Figure 5)
  - 8: Attach nut to aluminum pipe and feed the DC connector through the bottom of the driver compartment box. Attach pipe to driver box. (Figure 6)
  - 9: Connect the LED DC fixture input with the LED driver DC output connector. (Figure 7)
  - 10: Remove a knockout from the side of the driver compartment cover. (Figure 8)
  - 11: Connect the LED driver input leads to the input power. (Figure 9)
- NOTE: Installer **MUST** use wet rated wire connectors.
- 12: Replace and secure the driver compartment cover. (Figure 9)
  - 13: Restore power to the fixture.

**Figure 1**

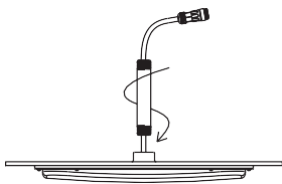

**Figure 2**

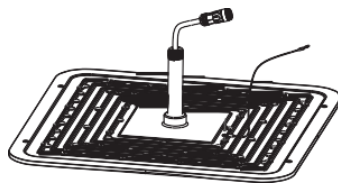

**Figure 3**

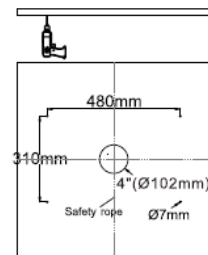

**Figure 4**

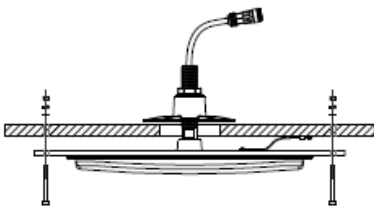

**Figure 5**

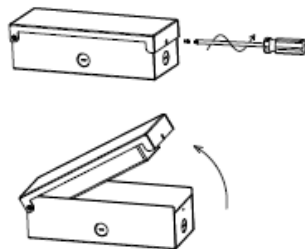

**Figure 6**

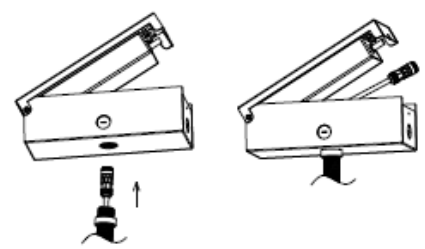

**Figure 7**

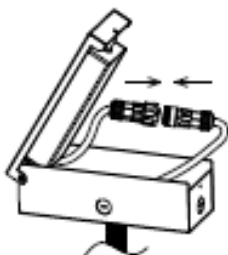

**Figure 8**

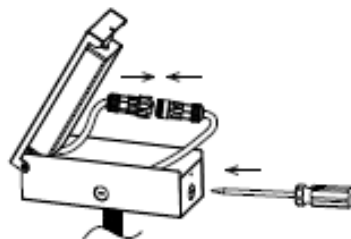

**Figure 9**

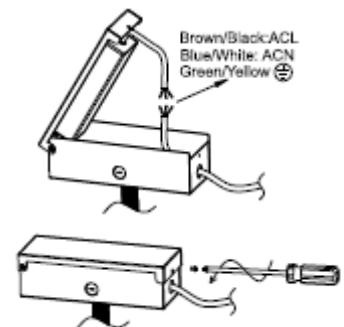

**(800) 451-2606**

7905 Cochran Road, Suite 300

Glenwillow, Ohio 44139 USA

E-mail: [Venture\\_Lighting@VentureLighting.com](mailto:Venture_Lighting@VentureLighting.com)

**VentureLighting.com**

